

Pepsi Little People's Golf Championships

Scorecards - KC

Divisions 1-B and 1-G (ages 3-5) will play 5 holes, holes #1-#2-#X-#8-#9, from the RED tees (approximately 469 yards)

Divisions 2-B and 2-G (ages 6-7) will play 9 holes, holes #1-#9, from the WHITE tees (approximately 930 yards)

Line along #3 denotes Out of Bounds

Line along #4 and #5 denotes Lateral Hazard

Line along #6 and behind #7 tee denotes Out of Bounds

Line behind #8 green and along #9 denotes Out of Bounds

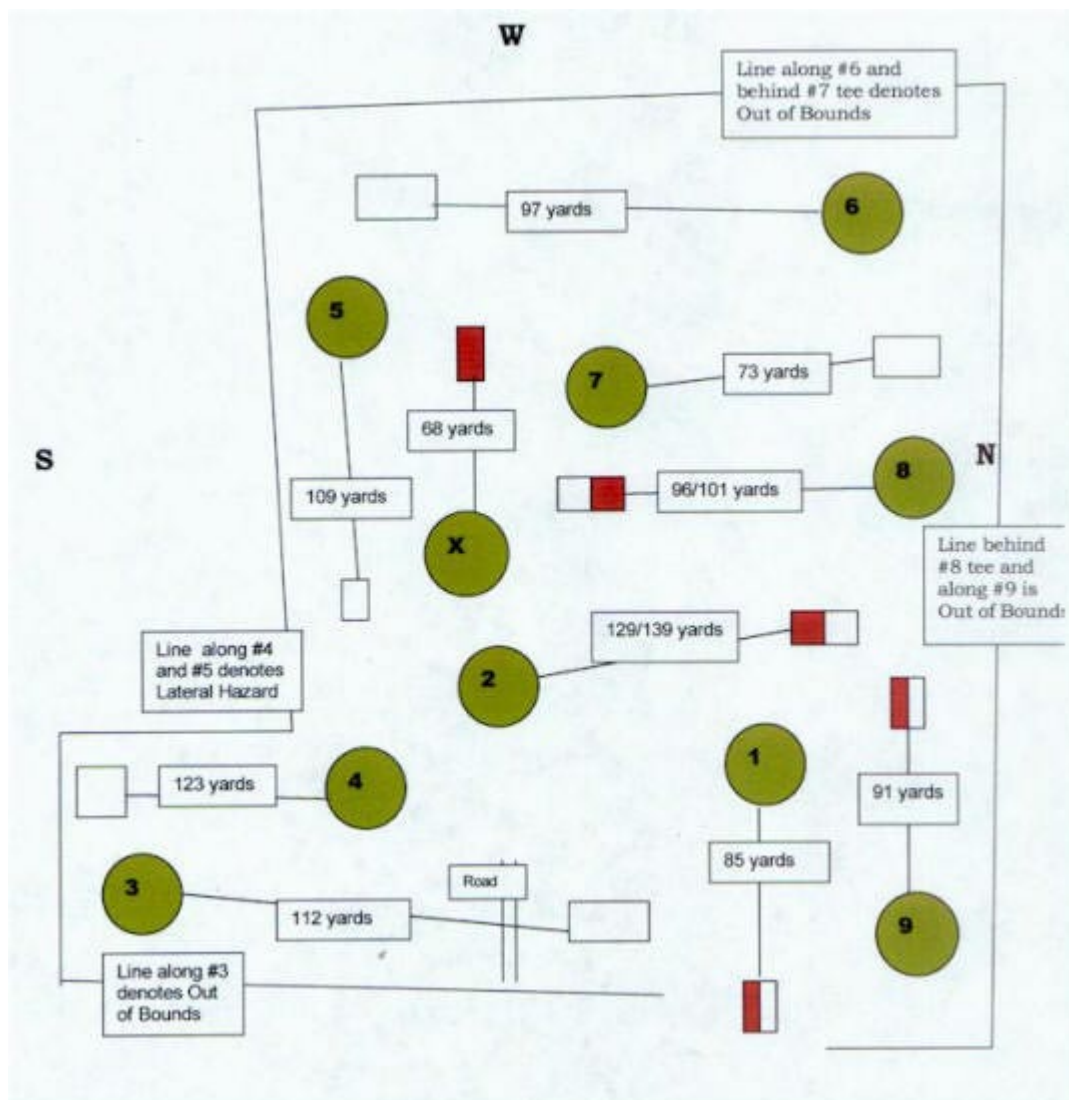

Players in Divisions 1 and 2 may:

- 1 Lay out of sand bunkers, no nearer hole, no penalty
- 2 Play preferred lies (winter rules) during all rounds. Lie, but NOT POSITION, may be improved any place on the course with hand or clubhead, six inches only, no nearer hole

There is NO ROUGH at KC Par-3. There is NO relief from trees on the course except those marked by stakes.

Players in Divisions 1 and 2 are limited to 12 strokes per hole, INCLUDING whiffs. Each player in Divisions 1 and 2 may have ONE caddie at a time, who may keep the scorecard. Please exchange scorecards but keep track of your own player's score. Compare scores after each hole. Caddie may change during a round, but player may have ONE caddie only at any time.

Please let your player play his/her own game as much as possible.

HOLE	YARDS	BOYS-PAR	GIRLS-PAR	HOLE	YARDS	BOYS-PAR	GIRLS-PAR
1	85	3	3	1	85	3	3
2	129	4	4	2	139	4	4
3	68	3	3	3	112	4	4
4	96	3	4	4	123	4	4
5	91	3	4	5	109	4	4
TOTAL	469	16	18	6	97	4	4
				7	73	3	3
				8	101	4	4
				9	91	3	4
				TOTAL	930	33	34